

THROTTLE POSITION SENSORS AND ACCESSORIES - CONTINUED -

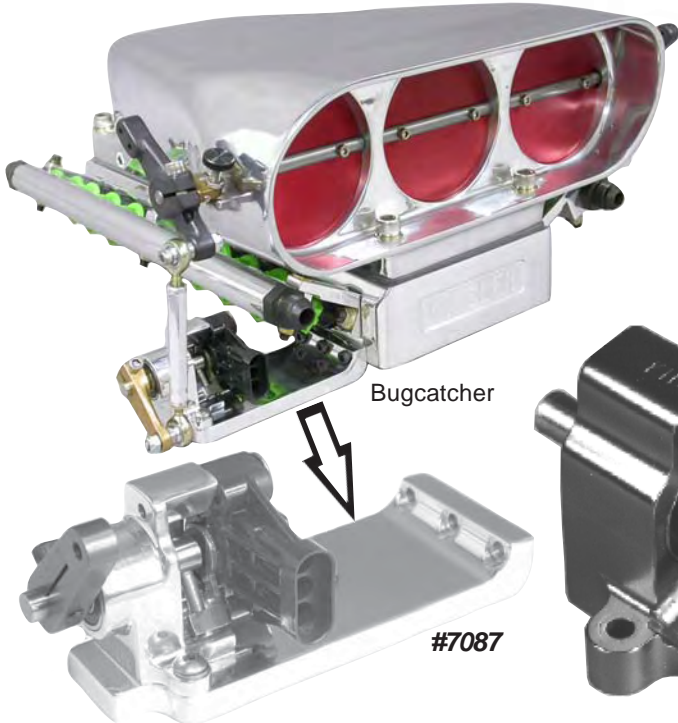

Bugcatcher

#7087

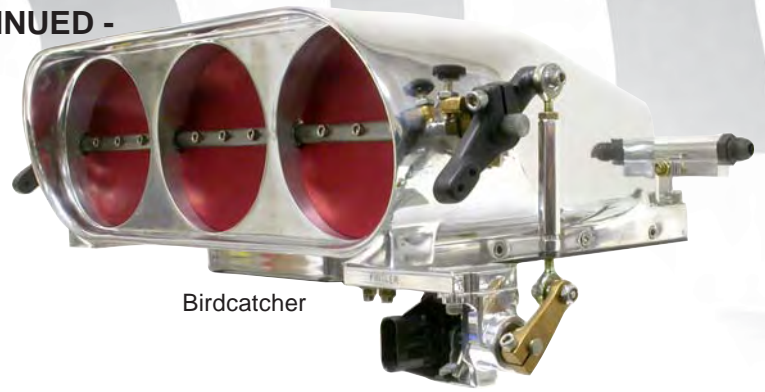

Birdcatcher

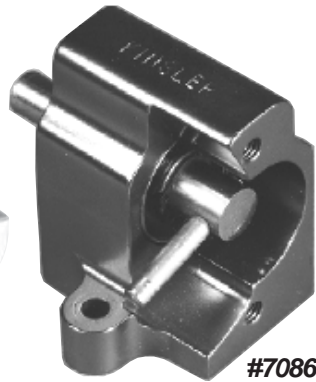

#7086

Remote TPS Mount

For Delco/CTS lever style TPS only. Excellent for adapting TPS when a shaft end is not accessible, or you want to drive the TPS at a different rate (by using different length throttle arms). 1.925" tall, two #10 mount holes (1.570" C-C). Billet aluminum housing with dual bearings for smooth operation. Weighs 0.3 lbs. Can be used to link T. P. S. to data acquisition system for use with EFI.

7086 For GM style T.P.S., with drive dog, shaft and ball bearings, polished or blue anodized (specify)

7087 For use with #7086 TPS, polished aluminum

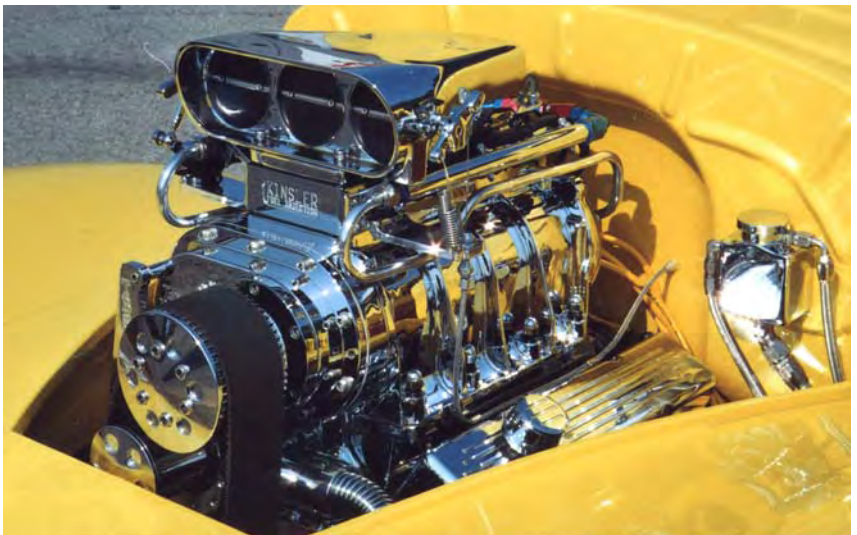

Frank Yarasezski's blown EFI Willy's



Al Maynard's 1967 Camaro



Alf Stellan's blown EFI GTO

© 2008